

# PDH02394

LDF Publication Draft Consultation  
Leeds City Council  
Forward Planning and Implementation  
The Leonardo Building  
2 Rossington Street  
Leeds LS2 8HD

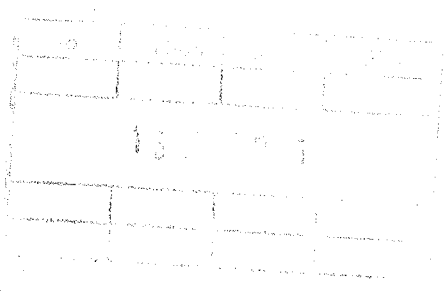

Name: *MRS. C. Walker*  
Address: *7 Arthington close  
Tingley  
NR. Wakefield  
WF3 1BT*

email:

Date: November 2015

Dear Sirs,

**LEEDS SITE ALLOCATIONS PLAN PUBLICATION DRAFT**  
**Response to consultation 22 September to 16 November 2015**  
**SITES HG2-168 AND HG2-169, HAIGH WOOD, WEST ARDSLEY**

I am objecting to housing sites HG2-168 (108 units) and HG2-169 (262 units) in Leeds City Council's Site Allocations Plan for the following reasons:

1. Development on this scale would virtually eliminate the open centre of West Ardsley and consolidate the semi-rural group of settlements into a predominantly urban residential area.
2. Development would impinge on Haigh Wood, its wildlife and the secluded rural valley which it is part of.
3. Local schools would not have the capacity to accommodate the extra children.
4. Local access roads are inadequate and their use would be contrary to the Council's own highway design standards.
5. No assessment has been made as to whether Tingley roundabout and the A653 Dewsbury Road can be improved sufficiently to cope with the extra traffic that would be generated by the development of these sites, by others in Tingley and by Kirklees' proposals at Chidswell.

I consider the plan to be unsound because it fails tests of being positively prepared, justified and effective in relation to these sites.

Yours faithfully,

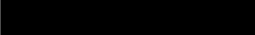
Signature.....  .....